

# Installation Instructions

# Seat Adapter Kit

Part No. 5600656

Fits Ferris IS700Z & Simplicity Citation XT Models

Kit Contents:		These components are pre-assembled as the seat spring assembly.			
Part No.	Qty.	Description	Part No.	Qty.	Description
5410583A	1	WELD, SEAT SWITCH	5100356	1	SPRING, .688 ID X .130 DIA, 4.25 LG
5021769	1	SWITCH, PLUNGER, NC	5025179X6	2	SCREW, #10-24 X 3/4"
5025271	2	NUT, #10-24 HEX NYLON LOCK	5025326	1	WASHER, 3/8" X 2"
5046586	1	SPACER, .38 X .50 X 5.06	5025013X48	1	BOLT, 3/8-16 X 6"
5025156	1	WASHER, 3/8 SAE	5025394	1	NUT, 3/8-16 HEX NYLOCK FLANGE
5410600	1	WIRE HARNESS, SEAT ADAPTER	5025155	3	WASHER, 5/16 SAE
5025011X8	3	BOLT, 5/16-18 X 1"	5025392	7	NUT, 5/16-18 HEX NYLOCK FLANGE
5025013X18	1	BOLT, 3/8-16 X 2-1/4 GD5 YZ	5025128	1	NUT, 3/8-16 HEX SERRATED FLANGE
5025394	1	NUT, 3/8-16 HEX NYLOCK FLANGE	5023310	1	MODULE, TIME DELAY
5021029	6	TIE, SELF-LOCKING, 12"			

## ⚠ WARNING



**Remove the ignition key prior to performing maintenance on the unit.**

Before beginning any service work turn off the PTO, engage the parking brake, turn off the ignition, remove the ignition key, and disconnect the spark plug wire(s).

**Purpose:** Installation of this kit is required prior to installing the upgraded seat to the unit. The upgraded seat is ordered separately through your normal parts source.

## Installing the Pre-Assembled Seat Spring Assembly

1. Park the machine on a flat, level surface such as a concrete floor. Disengage the PTO, engage the parking brake, turn off the ignition, and remove the key from the ignition.
2. Raise the seat plate.
3. Position the pre-assembled seat spring assembly (A, **Figure 1**) so that the spring goes up into the hole in the cross member of the frame labelled "1" and the two #10 nuts that retain the plunger switch fit into the slot in the frame labelled "2".
4. Secure the pre-assembled seat spring assembly to the frame of the unit using three (3) 5/16-18" bolts (B), 5/16 SAE washers (C), and 5/16-18 nylock flange nuts (D).

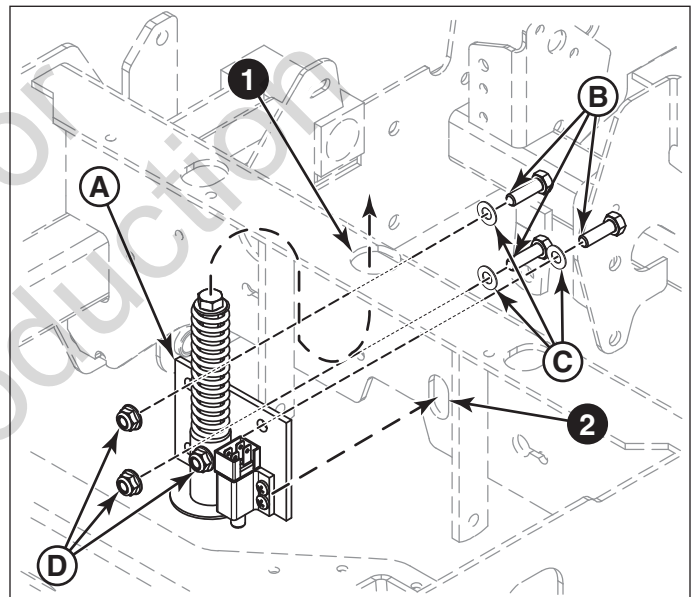
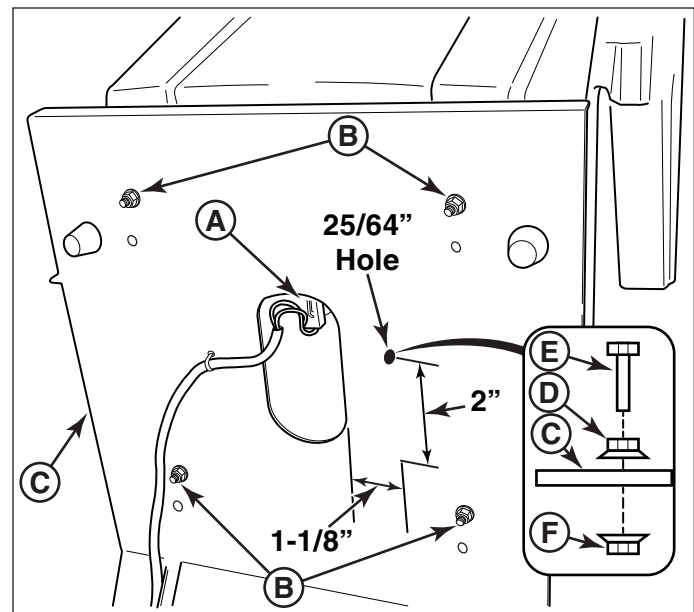

**Figure 1. Installing the Seat Spring Assembly**

## Installing the Stop Bolt & Wire Harness

1. Disconnect the wire harness (A, **Figure 2**) from the switch in the seat.

- Loosen and remove the four 5/16 nylock flange nuts (B) that retain the seat to the seat plate (C). Remove the seat.
- Using a 25/64" drill bit, drill a hole 1-1/8" from the right edge of the slot in the seat plate and 2" from the bottom of the slot in the seat plate. See Figure 2 for dimensional references.
- Install the 3/8 serrated flange nut (D) onto the 3/8 X 2-1/4" bolt (E) with the nut positioned so that the flange is away from the head of the bolt.
- Install the bolt down through the hole in the top of the seat plate and secure in place using the 3/8 nylock flange (F).
- Position the seat adapter wire harness (A, Figure 3) into the unit as shown in Figure 3. Connect the seat switch plug (B) to the switch on the pre-assembled seat spring assembly.



**Figure 2. Installing the Stop Bolt & Wire Harness**

- Using a 5/32" allen wrench, remove the three (3) allen head screws that secure the control panel to the right-hand fender tank.
- For models that DO have the optional headlight kit installed:** Disconnect the headlight wire harness from the "A" terminal of the ignition key switch. Plug the headlight wire harness into the "male" purple wire of the seat adapter wire harness (C). Install the "female" purple wire of the seat adapter harness (D) onto the "A" terminal of the ignition key switch.

**For models that DO NOT have the optional headlight kit installed:** Install the "female" purple wire of the seat adapter harness (D) onto the "A" terminal of the ignition key switch. The "male" purple wire of the seat adapter harness (C) is not used unless a headlight kit is installed.

- Plug the 5-lead connector (E) into the time delay module. Use a wire tie to secure the module to the wire harness under the dash.
- Reinstall the dash to the right-hand fender tank and secure in place using the three (3) allen head screws previously removed.
- Route the existing seat switch branch (F) of the unit's main wire harness that you disconnected from the old seat back along the same path the main trunk (G) of the unit's wire harness follows along the wire harness rail (H), through the grommet in the frame of the rail (I) and back towards the instrument control panel.
- For models that DO have the optional headlight kit installed:** Use wire ties to secure the seat switch branch of the unit's main wire harness to the unit's main wire trunk routed through the wire rail clamps (L). Use wire ties to secure the seat switch harness to the unit's main wire harness trunk routed through the face rail clamps (M).

**For models that DO NOT have the optional headlight kit installed:** Loosen the hardware that

secures the wire rail clamps (L) and face rail clamps (M). Place the seat switch branch of the unit's main wire harness trunk in the wire rail clamps. Place the seat switch harness in the face rail clamps. Tighten the hardware that secures the clamps.

- Using wire cutters, cut the seat switch connector off of the unit's main wire harness trunk and strip back 3/16" of the insulation.
- Install the bare wire into the butt connectors of the seat adapter kit wire harness and crimp the butt connector. The brown wire connects to the brown wire (J), and the white wire connects to the white wire (K).
- Locate the engine mounting bolt that secures both the main wire harness ground and the negative battery cable.
- Remove the nut from the engine mounting bolt, installed the ring-end of the seat adapter harness (N), and then re-install the nut.

## Installing the Upgraded Seat

The upgraded seat is purchased separately from this kit.

- Install the new upgraded seat onto the seat plate and secure using four (4) 5/16-18 nylock flange nuts (B, Figure 2). There are two sets of holes and the upgraded seat can be installed in either set of holes depending on the operator's preferred comfort adjustment.

## Check the Safety Interlock System for Proper Operation

This unit is equipped with safety interlock switches. These safety systems are present for your safety, do not attempt to bypass safety switches, and never tamper with safety devices. Check their operation regularly.

## Operational SAFETY Checks

### Test 1 - Engine SHOULD NOT crank if:

- PTO switch is engaged, OR
- Parking brake is not engaged, OR
- Ground speed control levers are not in the NEUTRAL position.

### Test 2 - Engine SHOULD crank if:

- PTO switch is not engaged, AND
- Parking brake is engaged, AND
- Ground speed control levers are locked in the NEUTRAL position.

### Test 3 - Engine should SHUT OFF if:

- Operator rises off seat with PTO engaged, OR
- Operator rises off seat with parking brake disengaged.
- Operator moves ground speed control levers out of their neutral positions before disengaging parking brake.

### Test 4 - Blade Brake Check

Mower blades and mower drive belt should come to a complete stop within seven (7) seconds after electric PTO switch is turned off (or operator rises off seat). If mower drive belt does not stop within seven (7) seconds, see your dealer.

*NOTE: Once the engine has stopped, PTO switch must be turned off, parking brake must be engaged, and the ground speed control levers must be locked in the NEUTRAL position after the operator returns to the seat in order to start the engine.*

## ⚠ WARNING

If the unit does not pass a safety test, do not operate it. See your authorized dealer. Under no circumstance should you attempt to defeat the purpose of safety interlock system.

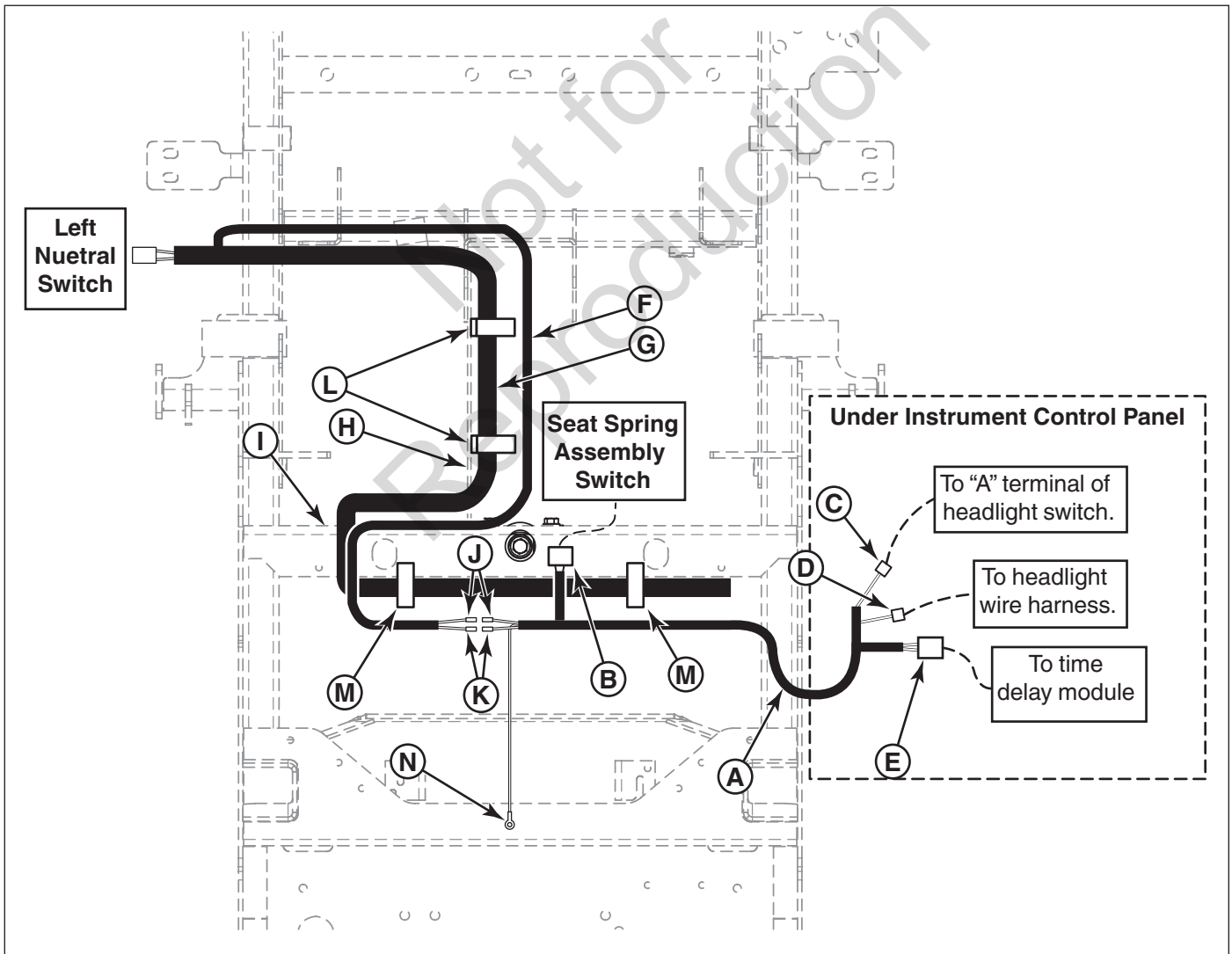

Figure 3. Installing the Wire Harness